

In Section J: Vacuum Refrigerators & Acc. Dishwasher Ranges & Acc. Washer/Dryer Water Heaters Furnace Fans Air Conditioners Generators

POWERHOUSE PH1000i INVERTER GENERATOR

1000 MAXIMUM WATTS

- Rated 900 Watts, Maximum 1,000 Watts • 120 Volts • Low noise, great for campground use • Inverter equipped for safe use with electronic equipment • Variable speed for fuel economy as power demands or constant speed for 100% full power • 1.63 hp (53cc) engine
- One 20 amp duplex receptacle • External circuit breaker on panel; internal breaker on inverter • 12V external charging system
- Lightweight; • Textured carry handle for easy transport
- EPA, CARB and CSA compliant; ISO 9001
- Two year consumer/one year commercial warranty

69270 1000 Watt Inverter Generator #PH1000i ♦₁



The easy to carry, economical, recoil-start PH1000i shares some advanced features with its larger siblings. For instance, it has an overload indicator light on its panel, and has a convenient Overload Reset button so you can restart the generator without shutting down the engine.



POWERHOUSE



PH3100Ri
Wheels are factory-installed for convenience

PH3100Ri Handle folds down when not in use



Open the door for easy maintenance

POWERHOUSE PH3100Ri INVERTER GENERATOR

• 3100 MAXIMUM WATTS • REMOTE CONTROL START

- Rated 3000 Watts, Maximum 3100 Watts • 120 Volts
- Remote electric start to 75'; key start and recoil start
- Variable speed for fuel economy as power demands, or constant speed for 100% full power
- Will operate 13,500 BTU RV air conditioners
- Inverter equipped for safe use with electronic equipment
- Low noise; great for campground use
- Powerful 6.8 hp (270cc) engine
- Engine reset button so if the unit is overloaded you don't have to restart the engine
- One 5-20R 20 amp duplex receptacle and one L5-30R 30 amp twist lock receptacle
- External circuit breaker on panel; internal breaker on inverter
- Fuel gauge • Hour meter
- Emergency stop control • Automatic choke
- Compact and powerful in a case
- Wheels installed (2 straight with brake and 2 swivel wheels for ease of transportation) • Padded handles
- 12 volt external charging system
- EPA, CARB and CSA compliant; ISO 9001
- Two year consumer/one year commercial warranty

69273 3100 Watt Inverter Generator #PH3100Ri ♦₆



POWERHOUSE PH2100PRi PARALLEL-READY INVERTER GENERATOR



2100 MAX. WATTS • PARALLEL READY • REMOTE CONTROL START

- Rated 2000 Watts, Maximum 2100 Watts • 120 Volts • Low noise, great for campground use • Inverter equipped for safe use with electronic equipment
- Variable speed for fuel economy as power demands or constant speed for 100% full power • 12 volt external charging system • 4.35 hp (125cc) engine
- Remote electric start (75'), key and recoil start • Parallel ready
- Automatic choke • One 20 amp duplex receptacle
- Convenient fuel primer bulb • External circuit breaker on panel; internal breaker on inverter
- Textured carry handle for easy transport
- EPA, CARB and CSA compliant; ISO 9001
- Two year consumer/one year commercial warranty

69271 2100 Watt Parallel-Ready Inverter Generator #PH2100PRi ◆1



Covered fuel filler keeps dirt off the cap



POWERHOUSE PH2700PRi PARALLEL-READY INVERTER GENERATOR

2700 MAXIMUM WATTS • PARALLEL READY • REMOTE CONTROL START

- Rated 2600 Watts, Maximum 2700 Watts • 120 Volts
- Remote electric start to 75'; key start and recoil start
- Variable speed for fuel economy as power demands, or constant speed for 100% full power
- Inverter equipped for safe use with electronic equipment
- Engine reset button so if the unit is overloaded you don't have to restart the engine • Low noise; great for campground use
- Powerful 5.1 hp (150cc) engine • Textured handle
- One 20 amp duplex receptacle
- Covered fuel fill
- External circuit breaker on panel; internal breaker on inverter
- Emergency stop control
- Convenient fuel primer bulb
- Automatic choke

- Compact and powerful in a suitcase style case
- 12 volt external charging system
- Carry handle and roll-along "wheelie" handle
- EPA, CARB and CETL compliant; ISO 9001
- Two year consumer/one year commercial warranty

69272 2700 Watt Parallel-Ready Inverter Generator #PH2700PRi ◆6



69276



"Wheelie" handle on PH2700PRi



BOOST YOUR POWER! Connect any two Powerhouse parallel-ready generators to provide extra power with the optional **69276** parallel kit. Examples: connect two PH2100PRi together or one PH2100PRi with one PH2700PRi to get a rated 4,000 watts (maximum 4,200 watts); connect two PH2700PRi together to get a rated 5,000 watts (maximum 5,200 watts). Generators and parallel kit sold separately. Approved for sale in the USA and Canada.

KIT FOR PARALLEL-READY GENERATORS

69276 Parallel Kit for PH2100PRi and/or PH2700PRi #PH21/27 1



Powerhouse generators include a **FREE** accessories kit that has items you pay extra for on some other brands: Oil Jug, 12V Charge Cable, Spare Spark Plug, Spark Plug Wrench & Handle, Manual, Keys and Remote, Oil Drain Extension. Accessories kits are customized for each generator model; some items are not in every model's kit.

POWERHOUSE INVERTER GENERATORS

MAJOR APPLIANCES

J

In Section J: Vacuum Refrigerators & Acc. Dishwasher Ranges & Acc. Washer/Dryer Water Heaters Furnace Fans Air Conditioners Generators

POWERHOUSE INVERTER GENERATOR SPECIFICATIONS



FEATURE	PH1000i (69270)	PH2100PRi (69271)	PH2700PRi (69272)	PH3100Ri (69273)
SPECIFICATIONS				
AC Output: Rated / Max (Watts)	900 / 1000 W	2000 / 2100 W	2600 / 2700 W	3000 / 3100 W
DC Output (A)	12 V-5 A	12 V-8.3 A	12 V-8.3 A	12 V-8.3 A
Maximum Current (A)	8.3 A	17.5 A	22.5 A	25.8 A
Maximum Engine Speed	5500 rpm	5000 rpm	5000 rpm	3600 rpm
Engine Type	Single Cylinder, 4-Stroke OHV, Air Cooled Gasoline	Single Cylinder, 4-Stroke OHC, Air Cooled Gasoline	Single Cylinder, 4-Stroke OHC, Air-Cooled Gasoline	Single Cylinder, 4-Stroke OHV, Air-Cooled Gasoline
Horsepower (hp) / Displacement	1.63hp / 53cc	4.35hp / 125cc	5.1hp / 150cc	6.8hp / 270cc
Starting System	Recoil	Remote, Electric & Recoil	Remote, Electric & Recoil	Remote, Electric & Recoil
Continuous Run Time (hr), Full load (1/4 load) per Tankful	3.7 hrs. (9.6 hrs.)	3.0 hrs. (7.5 hrs.)	2.9 hrs. (7.2 hrs.)	7.6 hrs. (17.8 hrs.)
Fuel Tank Capacity (Gal)	0.8 gal.	1.3 gal.	1.4 gal.	4.4 gal.
Generator Dimensions (in) (L x W x H)	18-1/8" x 9-13/16" x 15-1/8"	22" x 11" x 19"	22-3/4" x 13" x 17"	23-5/8" x 17-3/4" x 20-1/2"
Dry Weight (lb.)	30.8 lbs.	73 lbs.	80 lbs.	129 lbs.
Noise Level, dB @23': Zero load -Full load	55-64 dB	56-66 dB	58-67 dB	56-65 dB
Rated Current (A)	7.5 A	16.7 A	21.7 A	25 A
Rated Frequency (Hz)	60 Hz	60 Hz	60 Hz	60 Hz
Rated Voltage (V)	120 V	120 V	120 V	120 V
Receptacles	One 120 V, 20 A 5-20R Duplex	One 120 V, 20 A 5-20R Duplex	Two 120V, 20A 5-20R	One 120 V, 20 A 5-20R Duplex & One 120 V, 30 A L5-30R
Fuel Type	Unleaded Gasoline	Unleaded Gasoline	Unleaded Gasoline	Unleaded Gasoline
Oil Capacity	8.5 oz.	15.2 oz.	16 oz.	35 oz.
Oil Type	15W-40	15W-40	15W-40	15W-40
Spark Plug	A7RTC	A7RTC	A7RTC	F7RTC

FEATURES

Accessories Included	Oil Jug, 12 V Charge Cable, Spare Spark Plug, Spark Plug Wrench & Handle, Manual, Oil Drain Extension	Oil Jug, 12 V Charge Cable, Spare Spark Plug, Spark Plug Wrench & Handle, Manual, Keys & Remote, Oil Drain Extension, Spare 10A Glass Tube Fuse		
Automatic Low Oil Shutdown	Yes	Yes	Yes	Yes
Certifications	EPA, CSA, CARB, ISO 9001	EPA, CETL, CARB, ISO 9001	EPA, CETL, CARB, ISO 9001	EPA, CSA, CARB, ISO 9001
Choke	Manual	Auto	Auto	Auto/Elec
Electric Circuit Breaker	Inverter Controlled & Panel Mounted			
Fuel Economy Switch	Yes	Yes	Yes	Yes
Fuel Gauge	No	No	No	Yes
Hour Meter	No	No	No	Yes
Ignition System	Electronic Ignition	Electronic Ignition	Electronic Ignition	Electronic Ignition
Inverter Equipped	Yes	Yes	Yes	Yes
Overload Reset Switch	Yes	Yes	Yes	Yes
Parallel Ready	No	Yes	Yes	No
Phase	Single	Single	Single	Single
Primer Bulb	No	Yes	Yes	No
Remote Control	No	Yes	Yes	Yes
Structure	Enclosed	Enclosed	Enclosed	Enclosed
Wheels	No	No	2 Fixed & Handle	2 Fixed with Brakes, 2 Swivel

POWERHOUSE INVERTER GENERATOR REPLACEMENT PARTS

MODEL	GAS CAP	GAS FILL STRAINER	FUEL FILTER	AIR FILTER	SPARK PLUG	BATTERY
PH1000i	68501	69411	69407	69985	69412	N/A
PH2100PRi	69429	69411	69407	69800	69412	69783
PH2700PRi	69429	69411	69407	69425	69412	69436
PH3100Ri	69501	N/A	69407	69461	69537	69484

J MAJOR APPLIANCES CUMMINS ONAN GENERATORS & ACCESSORIES

In Section J: Vacuum Refrigerators & Acc. Dishwasher Ranges & Acc. Washer/Dryer Water Heaters Furnace Fans Air Conditioners Generators

CUMMINS ONAN RV QG REMOTE MUFFLER (formerly Camp Power)

The First Installed Generators For Travel Trailers, Truck Campers And Folding Camping Trailers.

RV QG 2500 REMOTE MUFFLER

- Runs one 13,500 BTU air conditioner with power to spare.
- Lightweight, compact design that's easy to install.
- Front access panel for easy service and maintenance.
- Fits truck campers and folding camping trailers.
- LP-fueled.



Cummins Onan



65281 2500 Watts LP Vapor Generator #2.5KVD-2089 ♦₁

CUMMINS ONAN RV QG (formerly Onan Microlite)

Lightweight, Compact and Quiet Gasoline/LP RV Generators.

RV QG 2800 & 2500



- Runs one 13,500 BTU air conditioner with power to spare and easy-start motor circuit.
- Lightweight, compact.
- Single-side service for easy maintenance.
- Fully-enclosed muffler.
- Gasoline or LP-fueled.

61939 2500 Watts LP Vapor Generator #2.5KV-FA/26120 ♦₁

64973 *2800 Watts Gasoline Generator #2.8KV-FA/26100 ♦₁

**Note: 64973 cannot be installed in California after 1/1/2008, or the other 49 States after 1/1/2012 if fueled from a separate tank from the propulsion engine.*

Cummins Onan



Note: 2.8 KV-FA/6050 Evaporative Control Model is designed for C.A.R.B. (California Air Resources Board) compliant applications effective 1/1/2008 and EPA Phase III (Class I) Standards effective 1/1/2012 using a fuel tank separate from the propulsion engine.

CUMMINS ONAN RV QG (formerly Onan Microquiet)

Lightweight, Compact and Quiet Gasoline/LP RV Generators.

RV QG 4000 & 3600

- Runs one 15,000 BTU air conditioner with power to spare and easy-start motor circuit.
- Lightweight, compact.
- Single-side service for easy maintenance.
- Fully-enclosed muffler.
- Gasoline or LP-fueled.
- Microprocessor control with diagnostics for easy troubleshooting.



Cummins Onan



67629 3600 Watts LP Vapor Generator #A028W068 ♦₁

65704 *4000 Watts Gasoline Generator #A028W021 ♦₁

**Note: 65704 cannot be installed after 1/1/2011 if fueled from a separate tank from the propulsion engine.*

Note: 4.0 KY-FA/6747 (A028W050) Evaporative Control Model is designed for C.A.R.B. (California Air Resources Board) compliant applications effective 1/1/2008 and EPA Phase III (Class II) Standards effective 1/1/2011 using a fuel tank separate from the propulsion engine.

In Section J:	Vacuum	Refrigerators & Acc.	Dishwasher	Ranges & Acc.	Washer/Dryer	Water Heaters	Furnace	Fans	Air Conditioners	Generators
---------------	--------	----------------------	------------	---------------	--------------	---------------	---------	------	------------------	------------

CUMMINS ONAN RV QG (formerly Onan Marquis Gold)

Fully Intergrated Design Makes It The Quietest In Its Class.

Cummins Onan



RV QG 5500, 6500 & 7000

- Runs one or two 13,500 BTU air conditioners with power to spare.
- Fully intergrated design makes it the quietest in its class.
 - Enclosed muffler
 - Low vibration levels
 - Self diagnostic capabilities to simplify troubleshooting
 - Digital voltage regulation for stability as appliance loads change.



- Gasoline or LP-fueled

RV QG 5500:

65115 5500 Watts LP Vapor Generator #5.5HGJAB-1119 ♦₁

65114 *5500 Watts Gasoline Generator #5.5HGJAB-901 ♦₁

RV QG 6500 & 7000:

65116 6500 Watts LP Vapor Generator #6.5HGJAB-904 ♦₁

65117 *7000 Watts Gasoline Generator #7.0HGJAB-900 ♦₁

Note: 5.5HGJAB-6755 & 7.0 HGJAB-6756 Evaporative Control Models are designed for C.A.R.B. (California Air Resources Board) compliant applications effective 1/1/2008 and EPA Phase III (Class II) Standards effective 1/1/2011 using a fuel tank separate from the propulsion engine.

***Note:** 65114 & 65117 cannot be installed after 1/1/2011 if fueled from a separate tank from the propulsion engine.



Cummins Onan General Gasoline and LP Accessories

MUFFLER KIT

For travel trailers and short bed trucks. Kit uses an approved flexible tube section between the manifold and muffler.

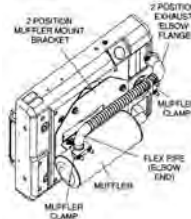

65805 Muffler Kit for KVD (can mount muffler in 2 different positions, and has integral flex tube) #541-1050 ₁

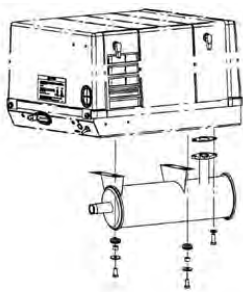

MUFFLER KIT

This kit is designed to fit most truck campers where the muffler can be mounted to the generator exhaust manifold and rear bracket. This kit must be assembled exactly per the instructions with no modifications or added hardware that extends the muffler.

65511 ^{LS} Muffler Kit for KYD 3600, 4000 #NULL ₁

MOUNTING KIT

For underfloor installations. Brackets and hardware included (Instruction Sheet #G-60). (Exhaust tailpipe not included.)

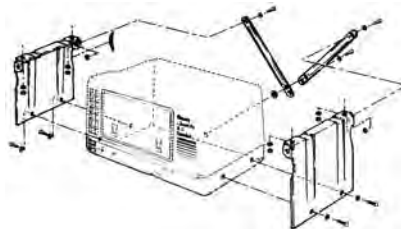

Travel trailer or fifth-wheel installations must be made in accordance with all applicable code requirements, including **ANSI A119.2**. (A copy of the ANSI A119.2 can be obtained from the Recreational Vehicle Industry Association, 1896 Preston White Drive, Reston, VA 22090.) **Also refer to the generator set installation manual for additional installation information and important safety precautions**

****Note:** For RV application only. This kit is not designed for use in commercial vehicles. All installations must be made in accordance with ANSI A119.2/NFPA 501C. Refer to the proper Cummins Onan instruction sheet and installation manual for recommendations and important safety precautions to follow when installing this kit.

67474 Mounting Kit for KV #403-2689 (X) ₁

ALUMINIZED STEEL TAILPIPE KIT

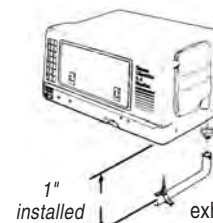

For KV applications from 18 inches to 25 inches (457 to 635 mm). Kit includes exhaust tube, hanger clamp, clamp and instructions. The exhaust tube is constructed of 16-gauge steel. The hanger clamps have a vibration isolated design to reduce rigid exhaust pipe stresses.

64976 Aluminized Tailpipe Kit #155-2325 (X) ₁

Stainless Steel Exhaust Tube Kit

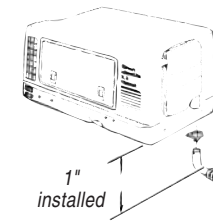

For KV applications of more than 25" (635 mm). Exhaust tube is 14" (356 mm) long and includes a vibration isolation section; designed for use with additional 1-1/2" O.D. standard exhaust tailpipe when required. Kit includes exhaust tube, hanger clamp, clamps and instructions. Additional hanger clamps may be necessary. (**63928**, #155-2174). The exhaust tube is constructed of seamless 16-gauge corrugated stainless steel for flexibility to reduce vibration stresses.

64977 Stainless Steel Tailpipe Kit #155-2324 (X) ₁

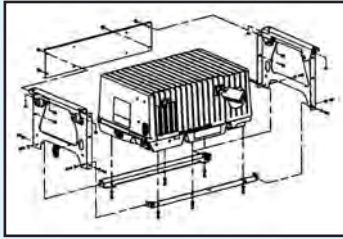

UNDERFLOOR MOUNTING KIT

For underfloor KY installations attaching directly to vehicle floor or floor supports. If template for mounting to the floor is required, order Part #539-1535-01 separately (Instruction Sheet #G-202).

65705 Underfloor Mounting Kit -KY
#403-3670 (X) 1

TAIL PIPE & EXHAUST KITS

Plan each individual exhaust system carefully. A proper installation is not only vapor-tight, but is quieter and safer. Be sure to **check all applicable recreational vehicle standards, and state and federal codes (including ANSI A119.2/NFPA 501C)** regarding exhaust installations for recreational vehicles. **Refer to the proper Cummins Onan instruction sheet and installation manual for recommendations and important safety precautions to follow when installing an exhaust system.**

TAILPIPE KIT

Contains tailpipe, clamp and a hanger that connects to the bottom of the mounting tray to direct exhaust to the side of the RV. Tailpipe hangs approximately one inch below the generator tray. Use on underfloor KY installations and those where the RV's sidewalls don't extend below the generator (Instruction Sheet #G-206).

For installations requiring additional clearance, also use **65713** (#155-2850) Exhaust Tube.

65706 Tail Pipe Kit -KY #155-2845 (X) 1

EXHAUST TUBE

12-inches long, 1-1/8" O.D. tube used as a down tube extension. It can be cut to length and other tailpipes added to it. Tailpipe Kit **65706** (#155-2845) can be added for above-floor installations if the sidewall is too low.

65713 Exhaust Tube -KY
#155-2850 (X) 1

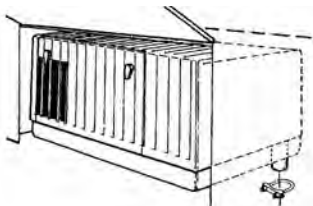

ELBOW ADAPTER

Contains the elbow and clamp from the muffler for a 90° turn to horizontal from the muffler outlet. The elbow expands to clamp on a 1-1/2" O.D. tailpipe. Additional tailpipe, clamp and a hanger will also be needed.

65710 Elbow Adapter Kit -KY
#155-2847 (X) 1

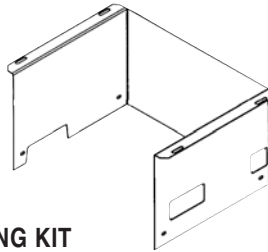

MOUNTING KIT

For underfloor HGJAB installation. (Exhaust tailpipe not included.) For RV application only.

65251 Mounting Kit
#405-6699 ◆ 1

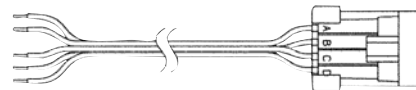

PIGTAIL TO SET

Pigtail that connects to the sealed remote connector on all gasoline and LP generator with sealed remote connector. (HGJAC, HGJAB, HGJAA, NHM/BGM Spec G and later, BGE/NHE Spec N and later, KY Spec F and later, KV Spec F and later, KVD and KYD).

61900 Pigtail Harness
#300-4946 1

TAIL PIPE & EXHAUST KITS

HGJAB RV generator sets have a built-in USDA Forest Service approved spark arrester muffler. *It is necessary to equip the generator set with a tailpipe at installation.*

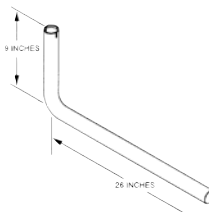

22" & 26" TAILPIPE

Contains tailpipe, clamp and a hanger. Exhaust tube connects to 1-3/8" O.D. down tube on generator.

Tailpipe HGJAB:

65228 22" #155-3481-01 1

65231 26" #155-3481-02 1

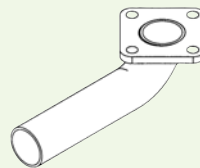

EXHAUST ELBOW

90° exhaust adapter elbow. Replaces standard 1-3/8" O.D. down tube. (For use with 1-3/8" I.D. tailpipe.)

69206 Exhaust Elbow -HGJAB
#A026E097 1

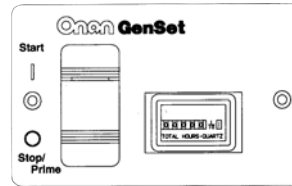

SWITCH & HOUR METER

For use with gasoline and LPG generators. Features an illuminated start/stop rocker switch and hourmeter with mounting plate. The kit includes mounting screws, panel assembly, and instruction sheet with mounting template. Cummins Onan extension harnesses Part #338-3489-01 and #338-3489-02 provide easy plug-in connection (Instruction Sheet #C-537).

Remote Switch and Hourmeter for Gasoline & LPG Gensets:

61967 Without Diagnostics (KV, KVD)
#300-4937 (X) 1

64908 With Diagnostics (KY, HGJAB)
#300-5332 1



10' & 30' REMOTE HARNESS

Easy plug connection between generators with remote sealed connectors and control panels (Part #300-4936, 300-4937, 300-4938, 300-5331, 300-5332 and 300-5333).

61992 10' Remote Harness
#338-3489-01 (X) 1

61993 30' Remote Harness
#338-3489-02 (X) 1

10' & 30' Remote Harness for QD

Easy plug-in connection between generators with remote sealed connectors and control panels 300-4942, 300-4943, 300-4944 and 300-5027.

66563 30' Remote Harness f/QD
#338-3490-02 1

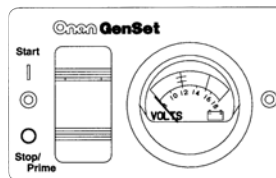

SWITCH & VOLT METER

For use with gasoline and LPG generators. Features an illuminated start/stop rocker switch and voltmeter with mounting plate. The kit includes mounting screws, panel assembly, and instruction sheet with mounting template. Cummins Onan extension harnesses Part #338-3489-01 and #338-3489-02 provide easy plug-in connection (Instruction Sheet #C-537).

Remote Switch and Voltmeter for Gasoline & LPG Gensets:

64912 With Diagnostics (KY, HGJAB)
#300-5333 1

In Section J: Vacuum Refrigerators & Acc. Dishwasher Ranges & Acc. Washer/Dryer Water Heaters Furnace Fans Air Conditioners Generators

SPECIAL COMPONENTS

CUMMINS ONAN OIL AND SERVICE/MAINTENANCE CHEMICALS

OnaMax™ Oil—Factory recommended and tested, maximum protection engine oil formulated to reduce consumption and engine wear due to high temperature oil oxidation and viscosity increase. One-quart bottle.

OnaFresh™ GXLP Fuel Stabilizer—A premium fuel additive, specially formulated for long-lasting prevention of gasoline breakdown during extended RV storage. Protects gasoline against gum, varnish, and sludge formation as well as fuel system corrosion. 16-oz. bottle treats 40 gallons of gasoline.

Onagard Storage Fogging Spray—Protects small engines and other mechanical equipment during off-season storage. Provides protection for up to six months. 12-oz. aerosol can.

Cummins Onan Premium Fuel System Cleaner—Promotes smoother, more efficient gasoline engine operation. Cleans dirty



carburetors and fuel injection systems; removes fuel system gum and varnish; reduces valve and intake deposits. 12-oz. bottle treats up to 24 gallons of gasoline.

4/C Combustion Chamber and Carburetor Cleaner—Removes power-robbing buildup of carbon, gum and varnish. Regular use can extend intervals between combustion chamber carbon maintenance cleanings. 12-oz. aerosol can provides carbon removal for one genset.

63964 OnaMax™ Oil, 15W40 #326-5336 12

63965 OnaMax™ Oil, 30W #326-5339 12

63963 OnaFresh™ #326-5365 12

63962 OnaGard #326-5288 1

68586 4/C Chamber & Carb Cleaner #326-5278 12

EXHAUST HANGER

Fits 1-1/2" O.D. exhaust tailpipe.

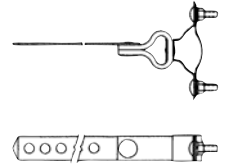

63928 Exhaust Hanger #155-2174 (X) 1

CLAMPS

The following clamps are marked according to the I.D. (inside diameter) of the tubing being clamped. Cummins Onan drawings specify "to fit a specific diameter," inch which is the O.D. (outside diameter) of the tubing. These two numbers differ by 1/8".

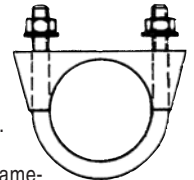

A=Tube O.D.; B=Tube I.D.; C=Clamp Stamped:

63927 A=1-1/4"; B=1-1/8"; C=1-1/8" #155-1256 1

63926 A=1-1/2"; B=1-3/8"; C=1-3/8" #155-1015 1

67614 LS A=1-5/8"; B=1-1/2"; C=1-1/2" #155-1239 1

Cummins Onan

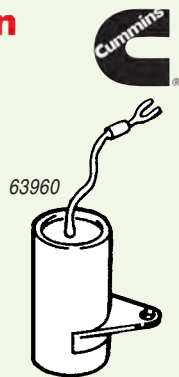

CUMMINS ONAN PARTS & ACCESSORIES

CUMMINS ONAN FUSE PACK

Fits most formerly Onan models, including Emerald I, II & III, Emerald Plus, NHE Spec A-F/NHEL Spec A-F beginning 9/98, Marquis 5000 & 7000, Microlite 2800/2500 & 4000, plus older models BF, BFA, BGA, BGAL, NH (Spec J-N), NH, NHL (begin Spec P).

67565 LS Fuse Pack #321-0278-01 6

MISCELLANEOUS CUMMINS ONAN PARTS

63960 LS Condenser #312-0256 1



ONAN OIL FILTER WRENCH

Cup-type oil filter wrench for easy removal of RV genset oil filters.

63972 Oil Filter Wrench (Fits Oil Filters 67584 and 67583 and all B and P series engines) #420-0559 1

THE CUMMINS ONAN EC-30W IS A WIRELESS GENERATOR AUTOSTART WITH THE FOLLOWING BENEFITS:

- Remotely starts and stops a generator from up to 100 ft away.
- Compatible with all current model Cummins Onan RV generators.
- Easy for any RV owner to install; instructions included (see how to install).
- Digitally encrypted code ensures remote starts only your generator.
- Rechargeable and can be wall mounted.
- Automatic generator turn on to meet air conditioning demands for up to four units.
- Regularly monitors and displays battery levels and provides power to the inverter to charge batteries.
- Unique "look-ahead" feature tops off battery prior to "quiet time".
- Easily program your own "quiet time" hours and battery charging preferences.
- Automatically starts/stops generator on low/full batteries.
- Displays generator hour meter, maintenance reminders and diagnostic text messages for easy troubleshooting.
- Safety start inhibits automatic generator starting in unsafe conditions.

EC-30W Wireless Autostart	Onan Part Number	KVD	KYD	KV	KY	HGJAB	QD	Price
S/O	#018-03000	•	•	•	•	•	•	
Y Harness if used in conjunction with a hard wired remote control panel								
66115	#044-00086	•		•				
66116	#044-00087		•		•	•		
66119	#044-00088						•	

Note: Y Harness required on Diesel units.



EC-30W

WHEN RELIABILITY COUNTS, INSIST ON THE REAL THING.

Brand Name Model/Series	Spec Letter	Tune-Up Kit		Oil Filter		Air Filter		Fuel Filter		Glow Plug or Spark Plug		Plug Wire	
		Onan #		Onan #		Onan #		Onan #		Onan #		Onan #	
		Order #	Price	Order #	Price	Order #	Price	Order #	Price	Order #	Price	Order #	Price
CUMMINS ONAN QG RV REMOTE (ONAN CAMP POWER™)													
KVD	A-B	Electronic Ignition		—		140-2105 63901		149-2137 61459		167-0263-02 60639		—	
KYD 50 Hz	A-B	Electronic Ignition		—		140-3280		149-2457		167-0305		—	
KYD 60 Hz						140-3280		149-2457		167-0275			
ONAN EMERALD ADVANTAGE™													
Gasoline/HGJAC	A-D	Electronic Ignition		122-0836		140-3116		***149-2629		167-1638		—	
LP Vapor/HGJAC				122-0836 65130		140-3116 65131		149-2648 65134		167-1638 65133			
ONAN EMERALD™													
BGE	A-E	160-1378		122-0645 67584		140-2379 60896		—		167-0272 64180		9" 167-1615-01 26" 167-1602	
Prior to 9/87 NHEL	F	160-1378		122-0645 67584		140-2379 60896		149-2279 65978		167-0272 64180		9" 167-1615-01 26" 167-1602	
Begin 9/87 NHEL		LS 160-1349-01 67559		122-0645 67584		140-2379 60896		149-2279 65978		167-0272 64180			
BGE	G	Electronic Ignition		122-0645 67584		140-2379 60896		149-2279 65978		167-0272 64180		9" 167-1615-01 26" 167-1602	
BGE	H	Electronic Ignition		122-0645 67584		140-2379 60896		149-1353 61454		167-0272 64180		9" 167-1615-01 26" 167-1602	
BGE	J-P	Electronic Ignition		122-0645 67584		140-2379 60896		149-2333 61460		167-0272 64180		9" 167-1615-01 26" 167-1602	
BGEL	A-E	160-1378		122-0645 67584		140-2379 60896		148-0898		167-0272 64180		9" 167-1615-01 26" 167-1602	
NHE	A-E	160-1378		122-0800 67583		140-2379 60896		—		167-0272 64180		9" 167-1615-01 26" 167-1602	
Prior to 9/87 NHE	F	160-1378		122-0800		140-2379		149-2279		167-0272		9" 167-1615-01 26" 167-1602	
Begin 9/98 NHE		LS 160-1349-01 67559		122-0800 67583		140-2379 60896		149-2279 65978		167-0272 64180			
NHE	G	Electronic Ignition		122-0800 67583		140-2379 60896		149-2279 65978		167-0272 64180		9" 167-1615-01 26" 167-1602	
NHE	H	Electronic Ignition		122-0800 67583		140-2379 60896		149-1353 61454		167-0272 64180		9" 167-1615-01 26" 167-1602	
NHE	J-P	Electronic Ignition		122-0800 67583		140-2379 60896		149-2333 61460		167-0272 64180		9" 167-1615-01 26" 167-1602	
NHEL	A-E	160-1378		122-0800 67583		140-2379 60896		148-0898		167-0272 64180		9" 167-1615-01 26" 167-1602	
ONAN MARQUIS™													
Gasoline/BGM	A-F	Electronic Ignition		122-0645 67584		140-2379 60896		149-2279 65978		167-0272 64180		9" 167-1625-01 23" 167-1625-02	
Gasoline/BGM	G-H			122-0645 67584		140-2379 60896		LS 149-2341 61462		167-0272 64180			
Gasoline/NHM	A-F	Electronic Ignition		122-0800 67583		140-2379 60896		149-2279 65978		167-0272 64180		167-1602	
Gasoline/NHM	G-H			122-0800 67583		140-2379 60896		LS 149-2341 61462		167-0272 64180		167-1602	
LP/NHM	All	Electronic Ignition		122-0800 67583		140-2379 60896		148-0898		167-0272 64180		167-1602	
CUMMINS ONAN RV QG (ONAN MARQUIS GOLD™)													
Gasoline/HGJAB	A-D	Electronic Ignition		122-0836		140-3116		***149-2629		167-1638		*** If replacing filter for fuel pump, please use #68657 (149-2341-01).	
LP/HGJAB				122-0836 65130		140-3116 65131		149-2648 65134		167-1638 65133			
CUMMINS ONAN RV QG EFI (ONAN MARQUIS PLATINUM™)													
EFI/HGJAA	A-D	Electronic Ignition		—		—		147-0860 69236		—		*** If replacing for carburetor, use #68659 (AO26E529).	
LP/HGJAA				122-0836 65130		140-3116 65131		149-2648 65134		167-1638 65133			
CUMMINS ONAN RV QG (ONAN MICROLITE™)													
KV	A-L	Electronic Ignition		—		140-2105 63901		149-2137 61459		167-0263-02 60639		149-2341-01 68657	
KVC	A-C			—		140-2609 65404		149-2457 64913		167-0305			
KY 50 Hz	A	Electronic Ignition		—		140-2609 65404		149-2457 64913		167-0305		A026E529 68659	
	B-H			—		140-3280 64633		149-2457 64913		167-0305			

CUMMINS ONAN REPLACEMENT PARTS

MAJOR APPLIANCES **J**

In Section J:	Vacuum	Refrigerators & Acc.	Dishwasher	Ranges & Acc.	Washer/Dryer	Water Heaters	Furnace	Fans	Air Conditioners	Generators			
Brand Name Model/Series S/O = Special Order	Spec Letter	Tune-Up Kit		Oil Filter		Air Filter		Fuel Filter		Glow Plug or		Plug Wire	
		Onan #		Onan #		Onan #		Onan #		Onan #		Onan #	
		Order #	Price	Order #	Price	Order #	Price	Order #	Price	Order #	Price	Order #	Price
KY 60 Hz	A	Electronic Ignition			140-2609		149-2457		167-0305	—			
	B-H				140-3280	64633	149-2457	64913	167-0275	—			
CUMMINS ONAN RV QG (ONAN MICROQUIET™)													
KY 50 Hz	J-L	Electronic Ignition	—		140-3280		149-2457		167-0305	—			
KY 60 Hz					64633	64913	167-0275	65639	—				
CUMMINS ONAN QD (ONAN QUIET DIESEL™)													
HDCAA	A-D	—	187-1000	64699	140-3071		149-2513		187-1289	—			
HDCAB					64739	64745	—						
HDKAK	L	—	122-0833	64698	140-2897	64730	147-0860	149-2513	185-5421	—			
HDKAH	L						69236						
HDKAH	K						64745	—					
HDKAJ	A-K	—	185-7444	65817	140-3351		149-2513		185-5421	—			
HDKAK					65814	64745	—						
HDKBA	A-D	—	122-0893	66582	140-3071	64739	149-2513	64745	LS 185-5990	—			
HDKCA	A-C	—	Reusable		140-4151		149-2834			—			
HDKCB										65815	—		
HDZAA	A-B	—	OLDER ONAN DIESEL GENERATORS										
HDKAG	A-B	—	LS 185-5835	64697	140-2842		LS 149-2106	63910	185-6623	—			
HDKAG	C								185-5421	—			
HDKAG	D-E								185-5421	—			
DKC RV	A	—	122-0827	63945	140-2842		149-1914-05	149-2106	185-2289	—			
DKC RV	B						63910			—			
DKD RV	A-B	—	122-0827	63945	140-2842		149-1914-05	149-2106	185-2289	—			
DKD RV	C-E						63910			—			
DKG	A	—	122-0827	63945	140-2680		LS 149-2106	63910	185-2289	—			
OLDER ONAN® GENERATORS													
BF Power Drawer	A	160-1154	122-0645	67584	140-1220		—	167-0262	167-1616-01				
BF RV	A-B	312-0069	—		140-0495			167-0237	—				
		LS 160-1328-01							67619	—			
BFA RV	A	160-1328-02	122-0645	67584	67587		—	167-0298	167-1616-01				
BFA RV	B-D	160-1348-01	67584					63941	—				
BGA RV	A	LS 160-1328-01	122-0645	67619	140-0495		—	167-0237	167-1616-01				
BGA RV	B-D	160-1348-01	67584	67587				167-0298	167-1616-01				
BGAL RV	C	160-1348-01	122-0645	67584	140-0495		—	167-0298	167-1616-01				
CCK Mobile/RV	A-Q	LS 160-0002	122-0800	67616	—		—	167-0237	167-1602				
CCK Mobile RV	R-U	312-0069	67583		140-0495		—		—				
LK RV	A-L	LS 160-0002	—		—		—	167-0237	—				
	M	312-0069			140-1220		149-1353	61454	—				
NH Power Drawer	A	160-1154	122-0800	67583	140-1229		—	167-0262	167-1616-01				
NH Power Drawer 9000	A-H	160-1154	122-0800	67583	140-1229		—	167-0262	167-1616-01				
		312-0069							—				
NH RV	A-H	LS 160-0002	122-0800	67616	140-0495	67587	—	167-0241	167-1616-01				
		312-0069						167-0247	—				
NH RV	J-N	LS 160-1328-01	67619					167-0272	167-1616-01				
NH RV	P-R	160-1378						64180	—				
NHL	P	LS 160-1328-01	122-0800	67619	140-0495	67587	—	167-0272	64180	9" 167-1615-01 26" 167-1602			

6 = Std. Carton Qty.

J MAJOR APPLIANCES CUMMINS ONAN GENERATOR SPECIFICATIONS

In Section J: Vacuum Refrigerators & Acc. Dishwasher Ranges & Acc. Washer/Dryer Water Heaters Furnace Fans Air Conditioners Generators

Cummins Onan gasoline, LP, and diesel generators are available in a variety of models to provide the best match for your RV.

GENERATOR APPLICATION

						
	KVD	KV	KY	HGJAB	HGJAA	RV QD

Model Number	2800/ 2500LP	2800/ 2500 LP	4000/ 3600 LP	5500/ 5500 LP	7000/ 6500 LP	5500	7000	6000/ 8000	10,000/ 12,500
--------------	-----------------	------------------	------------------	------------------	------------------	------	------	---------------	-------------------

Typical Generator Applications

Folding Camp Trailer	√								
Van & Truck Camper	√	√							
Travel Trailer		√	√						
Fifth-Wheel			√	√	√	√	√		
Class C, 1 A/C		√	√	√		√	√		
Class A, Gasoline, 1 or 2 AC			√	√	√	√	√		
Class A Diesel, 1A/C		√	√	√		√		√	
Class A Diesel, 2 A/C				√	√	√	√	√	√
Class A Diesel, 3 A/C									√

Specifications

Hertz	60	60	60	60	60	60	60	60	60
Fuel	Gasoline/ LP	Gasoline/ LP	Gasoline/ LP	Gasoline/ LPV	Gasoline/ LPV	Gasoline	Gasoline	Diesel	Diesel
Watts	2,800/ 2,500	2,800/ 2,500	4,000/ 3,600	5,500	7,000/ 6,500	5,500	7,000	6,000/ 8,000	10,000/ 12,500
RPM	3,600	3,600	3,600	2,400	2,880	2,400	2,880	Variable Speed	Constant Speed
Volts	120	120	120	120	120	120	120	120	120-240
Amps	23.3/20.8	23.3/20.8	33.3/30.0	45.8	58.3/54.2	45.8	58.3	50/66.6	83.3-41.7/ 104-52
Weight	107 lb.	113 lb.	172 lb.	279 lb.	290 lb.	279 lb.	290 lb.	420 lb.	780 lb.
Set Dimensions (LxWxH)*	19.6 x 16.7 x 12.3 in.	24.0 x 16.4 x 12.3 in.	30.0 x 19.7 x 14.4 in.	33.6 x 22.2 x 16.7 in.	33.6 x 22.2 x 16.7 in.	33.6 x 22.2 x 16.7 in.	33.6 x 22.2 x 16.7 in.	36.3 x 23.6 x 22.3 in.	41.4 x 24.5 x 27.0 in.

Average Fuel Consumption

No Load	0.2 /0.2 gph	0.2 /0.2 gph	0.3 /0.4 gph	0.3 /0.4 gph	0.3 /0.4 gph	0.3 gph	0.4 gph	0.1 gph	0.1 gph
Half Load	0.3 /0.3 gph	0.3 /0.3 gph	0.5 /0.6 gph	0.6 /0.8 gph	0.7 /0.8 gph	0.6 gph	0.7 gph	0.5 gph	0.43/0.48 gph
Full Load	0.4 /0.5 gph	0.4 /0.5 gph	0.7 /0.7 gph	0.9 /1.1 gph	1.2 /1.2 gph	0.9 gph	1.1 gph	1.0 gph	1.01/1.2 gph

Performance @ 100°F, 500 ft. Altitude (38°C, 152.4 M)

A/C Starting	One	One	One	One or Two	Two	One or Two	Two	Two	Three
Additional Watts	300-900	300-600	1600-2000	1300-3000	3,000	1300-3000	3,000	1600-3100	4,000

Engine Detail

No. Cylinders/Type	1/OHV	1/OHV	1/OHV	2/V-twin	2/V-twin	2/V-twin	2/V-twin	3/Inline	3/Inline
Cooling System Type	Air	Air	Air	Air	Air	Air	Air	Liquid	Liquid
Maximum Power (H.P.)	7.0	7.0	9.5/8.6	12.9/10.7	14.0/11.6	12.9	12.3	16.6	27

Sound Level @ 10 ft. (3 M) in dB(A)

@ Half Load (typical RV installation)	70	70	66	67	67	64	64	66	68
--	----	----	----	----	----	----	----	----	----